

SBTL2000 Series

SBTL2000 Single Lane Swing Barrier Turnstile

SBTL2011 Single Lane Swing Barrier Turnstile
(w/ controller and RFID reader)

SBTL2022 Single Lane Swing Barrier Turnstile
(w/ controller and fingerprint & RFID reader)

The ZKTeco SBTL2000 single lane swing barrier turnstile is an elegant cost-effective entrance control system designed for high-traffic volume.

The SBTL2000 is a single lane swing barrier turnstile series designed for smooth and silent operation and draws very little power. It's made of stainless steel which makes SBTL2000 highly durable.

SBTL2000 barriers are normally held in a locked position, thus denying access to the secured side. Upon SBTL2000's reader (RFID and/or fingerprint) positively recognizing a user's valid access card or fingerprint, its barriers swing automatically, thus allowing users passage to the secured side.

During emergencies the barriers automatically swing, thereby ensuring users FAST unencumbered exit to safety. During power outage, the user can push through the barrier easily to exit to safety.

SBTL2000 provides both security and convenient space, all in a very durable and elegant compact design.

Features

Reliability

- SUS304 stainless steel casework ensure long-lasting durability
- High quality electrical components

Safety Features

- Barriers swing automatically during emergencies
- All smooth finish. No exposed screws.
- Ergonomic design makes card and fingerprint authentication fast & simple for users.

Built-in Reader Integration

- SBTL2000 series ships already integrated with our customers' preference for either card or fingerprint access control reader. This greatly reduces installation time & expense.
- SBTL2000 series and associated access control readers are all factory-tested prior to shipping.
- ZKTeco provides true plug & play turnstiles with the lowest possible total cost of ownership in the industry.

Simplification

- Simplify structure and connection, easy to maintain.
- LCD display screen shows the current running status, easy operation.

Specifications

Power requirements		AC110V/220v,60/50HZ
Working temperature		28-°C~60°C
Working humidity		%5~%80
Working environment		Indoor/Outdoor
Speed of throughput	RFID	Maximum 42/ minute
	Fingerprint	Maximum 35/ minute
	Face	Maximum 11/ minute
	Vein	Maximum 23/ minute
Lane width(mm)		1050
Footprint(mm*mm)		1200*1610
Dimensions(mm)		L=1200,W=280,H=1000
Dimension with packing(mm)		L=1310,W=800,H=1100
Net weight(kg)		118
Weight with packing(kg)		160
LED indicator		Y
Cabinet material		SUS304 Stainless Steel
Lid material		SUS304 Stainless Steel
Barrier material		SUS304 Stainless Steel
Barrier movement		Swing
Emergency mode		Y
Security level		Medium
MCBF		2 million

Dimensions (mm)

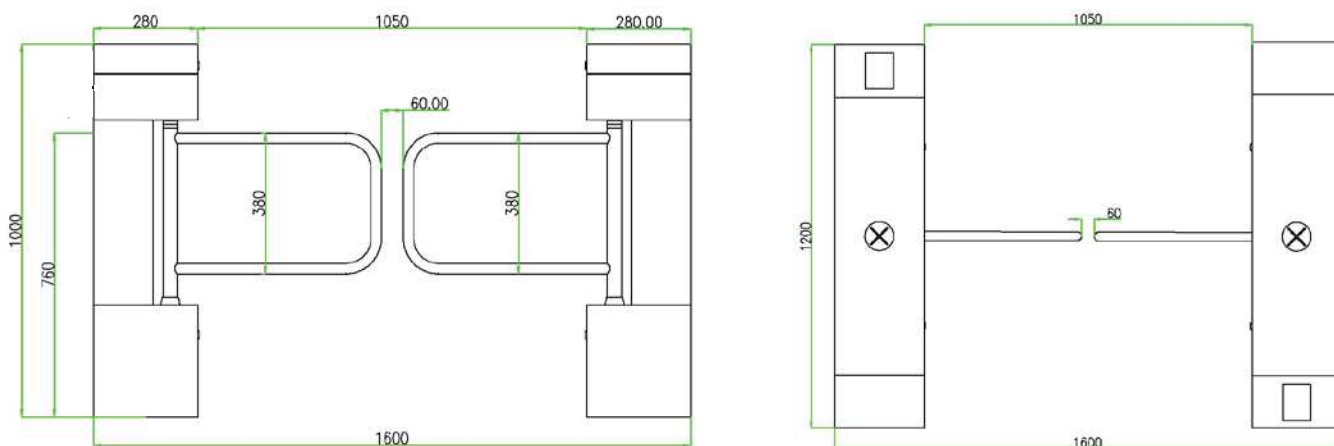

More details

ZKTECO CO.,LTD.
www.zkteco.com
 E-mail: sales@zkteco.com

© Copyright 2016. ZKTECO CO., LTD. ZKTeco Logo is a registered trademark of ZKTeco or a related company. All other product and company names mentioned are used for identification purposes only and may be the trademarks of their respective owners. All specifications are subject to change without notice. All rights reserved.

